

2010

Joey & Travel Trailer Floor Plans

Nomad[®]



Your local *Nomad* dealer is:

SKYLINE[®]

BRINGING AMERICA HOME. BRINGING AMERICA FUN.

Effective March 2009

Dare to Compare

	<u>SKYLINE®</u>	<u>Other Brand</u>
3-2-1 Warranty	✓	_____
Individually Weighed — <i>Certified</i> — Posted on Exterior	✓	_____
Rain Tunnel Tested	✓	_____
Simulated Road Tested (Shake Simulator)	✓	_____
Stile & Rail Cabinet Construction on Upper & Lower Cabinets	✓	_____
Seamless One-Piece Roof with Manufacturer's 12 Year Limited Warranty	✓	_____
Double-Wrapped & Sealed Exterior Metal Corners	✓	_____
Radius Clamp-Ring Windows	✓	_____
Radius Sealed Outside Compartment Doors	✓	_____
5/8" Tongue & Groove Floor	✓	_____
Cambered Chassis	✓	_____
R7 Insulation	✓	_____
Larger-Capacity Holding Tanks	✓	_____
Upgraded Name Brand Appliances	✓	_____
58 Years in Business	✓	_____

Since 1951, we've been building products that measure up to the expectations of our customers. From the very beginning, we've understood that our customers come first. You're the reason we're in business and every member of the Skyline team is committed to bring you nothing less than the best.

This commitment has earned Skyline its nationwide reputation for leadership and uncompromising integrity. Our designers, engineers, and production people work as a team to build RVs that meet your needs. The best RVs at the best prices. Each backed by a straightforward one-year full warranty and a nationwide customer service program that is short on red tape and long on results.

Skyline is a solid corporate citizen having no corporate debt and a strong cash position. Skyline has operated in the black every year since it was founded. In addition, three of Skyline's 15 nationwide manufacturing facilities are dedicated to RVs. For our customers, this means that Skyline has the financial muscle to stand in back of its products and you can count on the fact that Skyline will be around if you ever need us.

For us at Skyline, "*Bringing America Home. Bringing America Fun.*" is more than a slogan. It is a statement of our responsibility to a country that has been good to us. It is a pledge to extend our record of leadership, to continue the long tradition of superior service, and to strengthen the trust placed in us by the customers we are privileged to serve. It is our determination to serve America and its people with quality, affordable recreational vehicles for many years to come.

SKYLINE®

Interior

Cabinets

- Oak or Cherry Cabinets
- Drawers w/Travel-Lock Glide System

Decor

- Color-Coordinated Designer Interior
- Mini-Blinds for All Windows (Except over Bunks)
- Embossed Vinyl Flooring
- Extra Padded Dinette & Sofa Seat Cushions

Kitchen & Living Area

- Large Dometic® Refrigerator (4 cu. ft. on Model 153)
- Wedgewood® Three-Burner Cooktop
- Power Range Hood w/Light
- 25,000 Btu Furnace (18,000 Btu on Models 153, 172 & 193)
- 120 V to 12 V Power Converter
- Microwave Recept & Shelf
- TV Antenna
- Living Room TV Jack
- Park Cable for TV Hookup
- Acrylic Kitchen Sink
- Six Gal. Fast Recovery Gas Water Heater

Bedroom

- Color-Coordinated Quilted Bedspread (Most Models)
- Lift-up Bed Storage (Most Models)

Bath

- ABS Tub (Shower on Models 153 & 172)
- Medicine Cabinet w/Mirror
- Towel Ring

Exterior

Roof Construction

- Tapered Roof Construction to Promote Water Runoff
- Seamless One-Piece Roof w/12 Year Manufacturer's Limited Warranty
- Pre-Wired & Framed for Roof Air Conditioner
- Awning Drip Rail

Wall Construction

- Double Wrapped & Sealed Corners
- Wall Studs on 16" Centers (*Maximum*)
- Steel-Strap Reinforcement on Walls for Superior Durability
- R-7 Settle-Resistant Insulation
- Twist Locks on All Storage Doors
- Radius Clamp-Ring Windows
- Patio Convenience Light
- Entry Screen Door
- Entry Door Assist Handle

Chassis Construction

- Cambered Steel Frame Chassis w/Steel Outriggers
- Black Rotocast Wheel Wells (Most Models)
- Battery Rack
- Electric Brakes at All Wheels
- Safety Chains & Breakaway Safety Switch

Floor Construction

- 5/8" Tongue & Groove Floor Decking
- Tightly Sealed Woven Polyethylene Underbelly

Features

- Two 20 lb. Propane Tanks w/Changeover
- Holding Tanks w/Drain Outlet
- Rear Bumper w/Sewer Hose Carrier
- Color-Coordinated A&E® Side Awning

Security & Safety

- LP Gas Leak Detector
- Smoke Detector
- Carbon Monoxide Detector
- Fire Extinguisher
- Flush Door Latch w/Integral Dead Bolt Lock

Some Popular Options

- 13,500 Btu Dometic® Air Conditioner

Exterior Value Package

- Stabilizer Jacks – Two At Rear
- 30 lb. Propane Bottles
- Propane Bottle Cover
- Upgraded Exterior Graphics
- Goodyear® Tires

Interior Value Package

- Front Overhead Cabinet (Excluding Models 153 & 172)
- Hardwood Frame Cabinet Doors
- Microwave
- Monitor Panel
- Headboard (excluding Models 153 & 172)
- NLA Window Treatments
- Deluxe Wood Medicine Cabinet
- Water Heater By-Pass

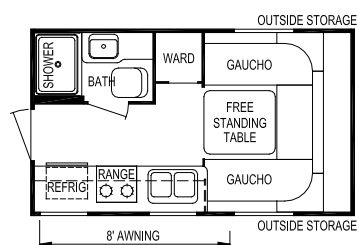

Model 153

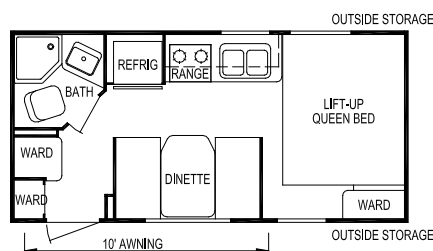

Model 172

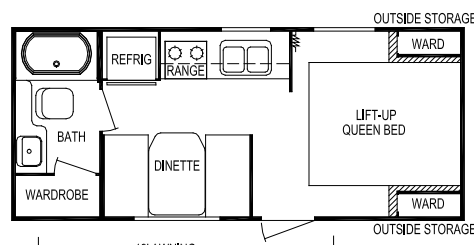

Model 193

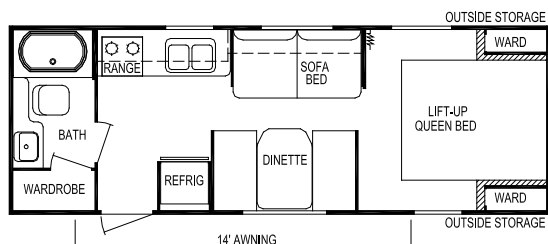

Model 209

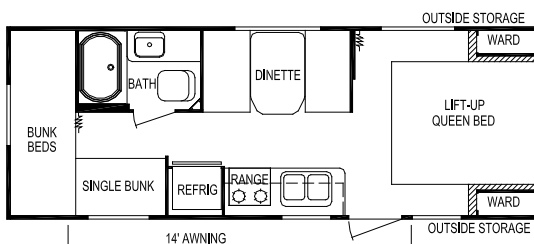

Model 246

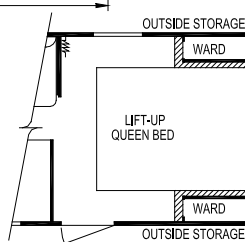

Option Front Entry (Model 209)

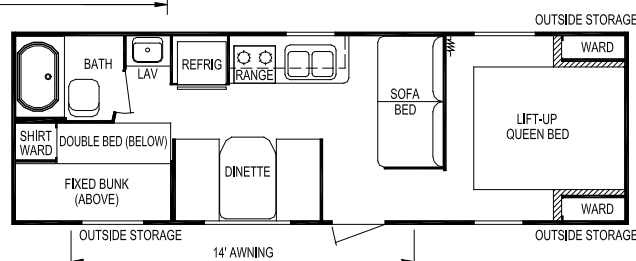

Model 263

Specifications

Model		153	172	193	209	246	263
Weights	Unloaded Vehicle Weight (see Note 2)	2,850	3,100	3,300	3,800	3,850	4,050
	Dry Hitch Weight	350	325	450	425	450	500
	Dry Axle Weight	2,500	2,775	2,850	3,375	3,400	3,550
	GVWR (Total Capacity of Trailer)	4,800	4,800	5,600	5,600	5,600	5,600
	Carrying Capacity (see Note 2)	1,900	1,575	2,175	1,650	1,600	1,400
Accommodations	Sleeping (standard / optional)	2	4	4	6	6	8
	Bed Size (standard)	N/A	60" x 74"	60" x 74"	60" x 74"	60" x 74"	60" x 74"
	Second Bed Size	N/A	N/A	N/A	N/A	(2) 32" x 90"	48" x 74"
	Dinette Size	60" x 80"	40" x 71"	40" x 71"	40" x 71"	(1) 28" x 76"	28" x 76"
Measurements	Exterior Length (see Note 3)	17'-5"	20'-1"	22'-2"	26'-4"	25'-8"	28'-11"
	Exterior Width (see Note 3)	96"	96"	96"	96"	96"	96"
	Exterior Height (see Note 3)	9'-11"	9'-11"	9'-11"	9'-11"	9'-11"	9'-11"
	Interior Height	76"	76"	76"	76"	76"	76"
Capacities	Fresh Water System (gallons)	36	36	36	36	36	36
	Gray Water Tank (gallons)	31	31	31	31	31	31
	Black Water Tank (gallons)	31	31	31	31	32	31
	Awning Size	8'	10'	12'	14'	14'	14'
	Converter Size (amps)	55	55	55	55	55	55
	Furnace Rating (Btu)	18,000	18,000	18,000	25,000	25,000	25,000
	Propane Gas Capacity (pounds)	40	40	40	40	40	40
	Tires (see Note 4)	205/75R14-C	205/75R14-C	205/75R14-C	205/75R14-C	205/75R14-C	205/75R14-C
	Water Heater (gallons)	6	6	6	6	6	6

Notes

- (1) All weights, dimensions, and capacities shown are approximate values.
 (2) Unloaded vehicle weight and carrying capacity will vary depending upon optional equipment. Full propane tanks are factored into carrying capacity. Skyline weighs every unit at the factory. See trailer weight information label located inside the front entry door for specific unloaded vehicle weight and cargo carrying capacity.
 (3) Dimensions stated to industry standards. Exterior length includes approximately a four foot hitch on travel trailers. Exterior height includes air conditioner, if installed. Exterior width does not include the width of the awning, if installed.
 (4) Goodyear® Marathon ST Radial tires are a required option — part of exterior value package.

Interior

Cabinets

- Oak or Cherry Cabinets
- Drawers w/Travel-Lock Glide System

Decor

- Color-Coordinated Designer Interior
- Mini-Blinds for All Windows (Except over Bunks)
- Embossed Vinyl Flooring
- Extra Padded Dinette & Sofa Seat Cushions

Kitchen & Living Area

- Large Dometic® Refrigerator
- Wedgewood® Three-Burner Cooktop
- Power Range Hood w/Light
- 25,000 Btu Furnace
- 120 V to 12 V Power Converter
- Microwave Recept & Shelf
- TV Antenna
- Living Room TV Jack
- Park Cable for TV Hookup
- Acrylic Kitchen Sink
- Six Gal. Fast Recovery Gas Water Heater

Bedroom

- Color-Coordinated Quilted Bedspread (Most Models)
- Lift-up Bed Storage (Most Models)

Bath

- ABS Tub
- Medicine Cabinet w/Mirror
- Towel Ring

Exterior

Roof Construction

- Tapered Roof Construction to Promote Water Runoff
- Seamless One-Piece Roof w/12 Year Manufacturer's Limited Warranty
- Pre-Wired & Framed for Roof Air Conditioner
- Awning Drip Rail

Wall Construction

- Double Wrapped & Sealed Corners
- Wall Studs on 16" Centers (*Maximum*)
- Steel-Strap Reinforcement on Walls for Superior Durability
- R-7 Settle-Resistant Insulation
- Twist Locks on All Storage Doors
- Radius Clamp-Ring Windows
- Patio Convenience Light
- Entry Screen Door
- Entry Door Assist Handle

Chassis Construction

- Cambered Steel Frame Chassis w/Steel Outriggers
- Black Rotocast Wheel Wells (Most Models)
- Battery Rack
- Electric Brakes at All Wheels
- Safety Chains & Breakaway Safety Switch

Floor Construction

- 5/8" Tongue & Groove Floor Decking
- Tightly Sealed Woven Polyethylene Underbelly

Features

- Two 20 lb. Propane Tanks w/Changeover
- Holding Tanks w/Drain Outlet
- Rear Bumper w/Sewer Hose Carrier
- Color-Coordinated A&E® Side Awning

Security & Safety

- LP Gas Leak Detector
- Smoke Detector
- Carbon Monoxide Detector
- Fire Extinguisher
- Flush Door Latch w/Integral Dead Bolt Lock

Some Popular Options

- 13,500 Btu Dometic® Air Conditioner

Exterior Value Package

- (4) Stabilizer Jacks
- Spare Tire, Carrier & Cover
- 30 lb. Propane Bottles
- Propane Bottle Cover
- Double Entry Step (Model 264)
- Outside Shower
- Upgraded Exterior Graphics
- Goodyear® Tires

Interior Value Package

- Stereo w/Outside Speakers
- Monitor Panel
- Range w/Oven
- Microwave
- Double-Door Refrigerator
- Tub Surround

- Shower Curtain Valance
- 6 Gallon DSI Water Heater
- Water Heater By-Pass
- Deluxe Wood Medicine Cabinet
- Deluxe Refrigerator Insert
- Front Bedroom Overhead
- Bedroom Carpet
- Deluxe Headboard
- Upgrade Window Treatments w/Lambrequin Legs (Excluding Kitchen & Bunk)
- Living Room Wall Border
- Oval Wall Mirror
- Pleated Night Shades
- Hardwood Frame Doors
- Decorative 12 V Light Above Dinette in Slide-Out Room Only
- Decorative 12 V Wall Light(s) at Sofa in Slide-Out Room Only

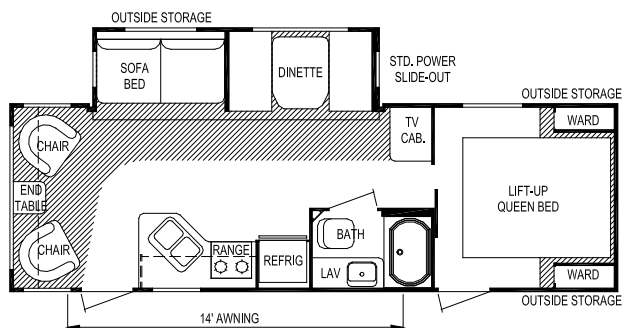

Model 262

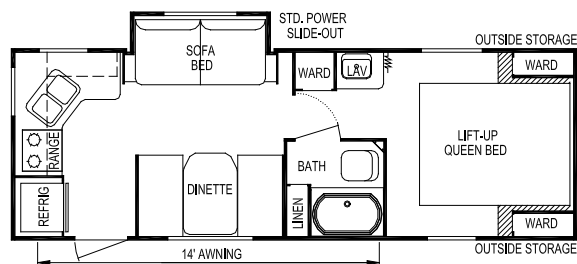

Model 264

Specifications

Model	262	264	282	295	297	311
Weights						
Unloaded Vehicle Weight (see Note 2)	5,725	4,275	6,075	6,050	6,650	7,400
Dry Hitch Weight	650	600	800	750	950	850
Dry Axle Weight	5,075	3,675	5,275	5,300	5,700	6,550
GVWR (Total Capacity of Trailer)	7,750	6,200	7,750	7,750	11,200	11,200
Carrying Capacity (see Note 2)	1,825	1,750	1,450	1,475	4,300	3,550
Accommodations						
Sleeping (standard / optional)	6	6	9	9	8	8
Bed Size (standard)	60" x 74"	60" x 74"	60" x 74"	60" x 74"	60" x 74"	60" x 74"
Dinette Size	40" x 71"	40" x 71"	40" x 71"	48" x 79"	48" x 79"	48" x 79"
Measurements						
Exterior Length (see Note 3)	29'-4"	26'-8"	31'-4"	32'-11"	32'-9"	35'-4"
Exterior Width (see Note 3)	96"	96"	96"	96"	96"	96"
Exterior Height (see Note 3)	11'-0"	9'-11"	11'-0"	11'-0"	11'-0"	11'-2"
Interior Height	78"	76"	78"	78"	78"	78"
Capacities						
Fresh Water System (gallons)	36	36	46	36	36	36
Gray Water Tank (gallons)	40	62	40	40	40	40
Black Water Tank (gallons)	40	31	40	40	40	40
Awning Size	14'	14'	14'	18'	21'	21'
Convertor Size (amps)	55	55	55	55	55	55
Furnace Rating (Btu)	25,000	25,000	25,000	25,000	25,000	25,000
LP Gas Capacity (pounds)	40	40	40	40	40	40
Tires (see Note 4)	205/ 75R15-C	205/ 75R14-C	205/ 75R15-C	205/ 75R15-C	225/ 75R15-D	225/ 75R15-D
Water Heater (gallons)	6	6	6	6	6	6

Notes

- (1) All weights, dimensions, and capacities shown are approximate values.
- (2) Unloaded vehicle weight and carrying capacity will vary depending upon optional equipment. Full propane tanks are factored into carrying capacity. Skyline weights every unit at the factory. See trailer weight information label located inside the kitchen cabinet door for specific unloaded vehicle weight and carrying capacity.
- (3) Dimensions stated to industry standards. Exterior length includes approximately a four foot hitch on travel trailers. Exterior height includes air conditioner, if installed. Exterior width does not include the width of the awning, if installed.
- (4) Goodyear® Marathon ST Radial tires are a required option — part of exterior value package.

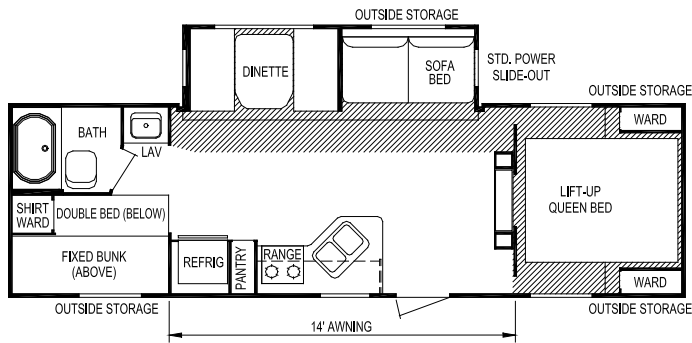

Model 282

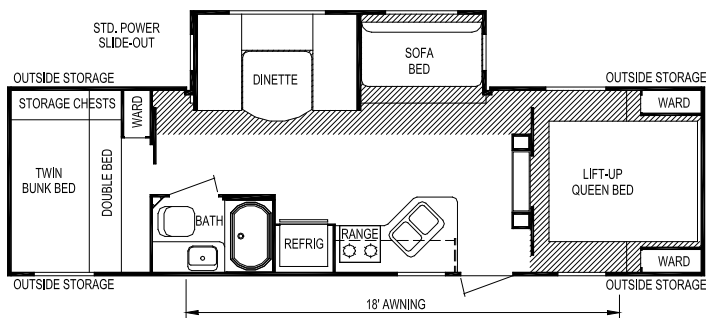

Model 295

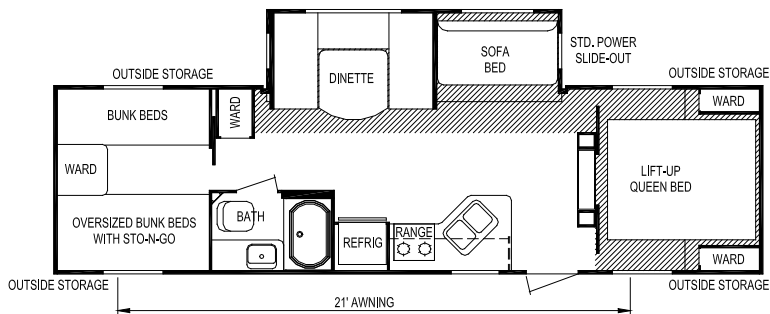

Model 297

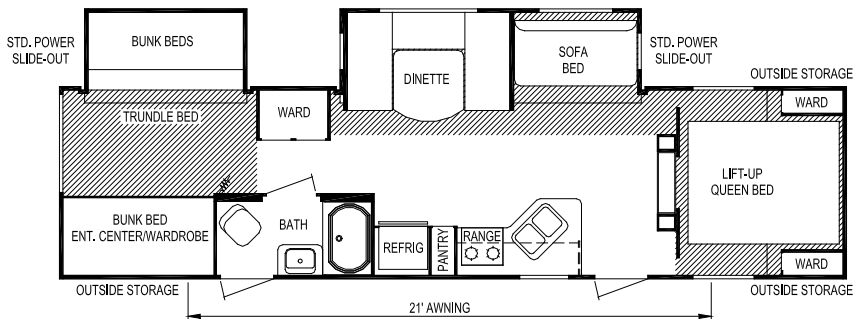

Model 311



Skyline Customer Satisfaction

Skyline Customer Satisfaction is more than just a promise. We believe you deserve quality in every aspect of ownership. To ensure your continued satisfaction, we're dedicated to providing you with a quality product along with the very best service available in our industry. Skyline's "Commitment of Excellence" will be a source of pride and satisfaction for you.

Contact your Skyline dealer for details.

SKYLINE	
<i>Commitment of Excellence</i>	
OWNER	SATISFIED CUSTOMER
ORIGINAL DEL. DATE	DEALER NO.
VEHICLE ID NO.	MODEL NO.
BRINGING AMERICA HOME. BRINGING AMERICA FUN.	

NO-NONSENSE WARRANTY

Manufacturing defects reported to Skyline within one year after original retail delivery of your new Travel Trailer or Fifth Wheel by an authorized dealer will be corrected without charge and within reasonable times. Excluded are misuse (including lack of reasonable maintenance), minor imperfections, alterations, and dealer or owner improper transportation, installation, or hookup.

This warranty gives you specific legal rights. You may have other rights which vary from state to state.

Skyline's suppliers often provide additional warranties on their components beyond the Skyline factory bumper-to-bumper warranty. For example — the range, water heater, furnace and convertor carry two-year supplier warranties while the air conditioner, refrigerator, microwave and awning carry three-year warranties. The one-piece roof carries a 12-year warranty. Ask your dealer for full details.

Manufacturer's Notice: All specifications, equipment, and prices are subject to change without prior notice. Production of all models subject to seasonal scheduling. Skyline Corporation reserves the right to improve a model without incorporating these changes in similar models produced at an earlier date.

Consult your automobile dealer and your recreational vehicle dealer to assure the proper match between tow vehicle and trailer. Tow vehicle and recreational unit must be properly equalized for efficient product performance and safety. Before you purchase your recreational vehicle, carefully consider the number of people it will accommodate and its end use. Manufacturer's load capacity restrictions and recommendations must be followed for safe and efficient product performance.

Your Retailer, an independent contractor, who is not an agent of Skyline Corporation, is the party responsible for your purchase contract and any additions, deletions, alterations, or attachments made to or in your recreational vehicle.



For the name of your nearest Skyline-built RV dealer, call:
Hemet, CA 1-888-442-0997
Mansfield, TX 1-800-962-7773
Elkhart, IN 1-800-736-2573

Or visit us at our Web Site at www.skylinecorp.com

Go RVing
Life's A Trip™