

# Express SUPER LITE

by Passport



## MORE

- 8' Wide Construction
- 78" Interior Ceiling Height
- 32 cu. ft. of Pass Thru Storage
- 30/30/30 Holding Tank Capacity
- Crossover & SUV Towable Floorplans\*

go anywhere



# MORE for LESS

186 ML

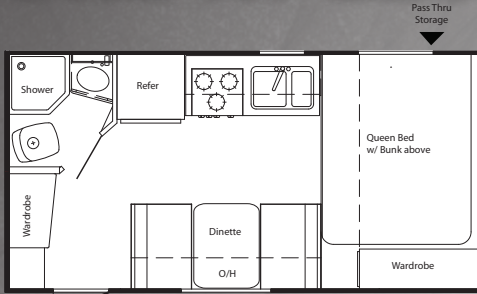

189 ML

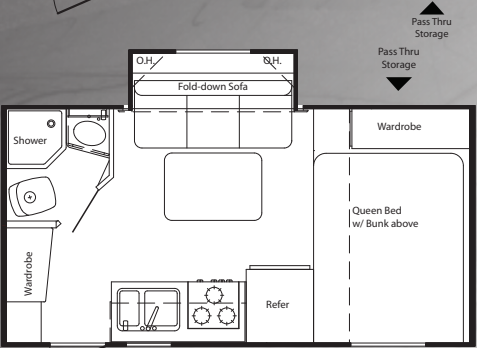

199 ML

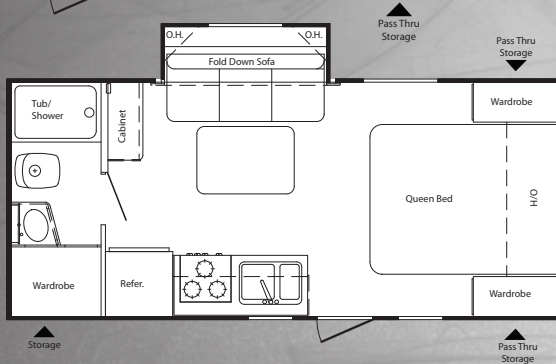

	186 ML	189 ML	199 ML
Shipping Weight	TBD	3275	TBD
Carrying Capacity	TBD	2570	TBD
Hitch	TBD	245	TBD
Exterior Length	TBD	19'	TBD
Exterior Height	TBD	10' 1"	TBD
Fresh Water gal.	TBD	30	TBD
Waste Water gal.	TBD	30	TBD
Grey Water gal.	TBD	30	TBD
LPG Capacity lbs.	TBD	40	TBD

## Standard Features

### CHASSIS

- Fully welded outriggers
- 100% Powder "E" coated
- Extra support cross members
- Electric slide out system

### CONSTRUCTION

- 8' Wide construction
- Welded aluminum framed sidewalls
- Laminated gel-coated filon exterior walls
- Bead foam insulation in sidewalls (R-7 insulation)
- Laminated aluminum framed floor 2" thick
- R-11 floor insulation
- Galvanized 5" thick crowned rafters
- One piece seamless rubber roof
- R-11 ceiling insulation
- 78" Interior ceiling height

### EXTERIOR FEATURES

- Insulated lockable radius baggage doors with hold backs
- Insulated radius entrance door with screen door
- Heavy duty front mechanical jack
- 2-20lb. Propane bottles with cover
- Rain gutters with downspouts
- Color coordinated awning
- Lighted exterior pass thru storage compartment
- Outside cook center
- Patio entrance light
- Exterior shower w/ hot & cold
- Front diamond plate
- EZ lube axles
- Exterior speakers

### INTERIOR FEATURES

- Residential style furniture with high grade fabric
- 13.5 BTU A/C
- Forced air furnace
- 6 gallon gas/electric DSI water heater
- Water system winterization kit

- Residential grade durable linoleum
- 12-volt CD/DVD/AM/FM stereo with aux input & quality sound speakers
- 15" LCD flat screen TV

### KITCHEN

- Double door refrigerator
- Oversized 60/40 residential sink
- Microwave with carousel
- 3-burner high output range
- Range hood with 12-volt exhaust fan and light
- Metal high-rise faucet
- Residential hardwood cabinet doors
- Coordinated wall paper border

### BATHROOM

- Medicine cabinet with mirror
- Tub surround
- Shower curtain
- Foot pedal flush toilet
- 12 volt power exhaust fan

### SAFETY PACKAGE

- 4 wheel electric brakes
- Break-away switch
- Heavy duty safety chains with clasp
- Tinted safety glass windows
- GFI receipts
- Carbon monoxide detector
- Smoke alarm
- Fire extinguisher
- Propane gas leak detector
- Dead-bolt lock on entrance doors
- Manual override on slide system
- Spare tire kit



1. Aluminum sport wheels
2. 15" LCD HD TV with DVD/CD/AM/FM stereo



3. Portable outside grill with LP connection
4. Oversized lighted pass-thru storage compartment



Your PASSPORT dealer:



[www.keystone-passport.com](http://www.keystone-passport.com)

2642 Hackberry Dr. • Goshen, IN 46526  
(574) 535-2100

\*Product information is as accurate as possible as of the date of publication of this brochure. Features, floor plans, and specifications are subject to change without notice. Please also consult Keystone's web site at [www.keystonerv.com](http://www.keystonerv.com) for more current product information and specifications. Tow Vehicle disclaimer: CAUTION: Owners of Keystone recreational vehicles are solely responsible for the selection and proper use of tow vehicles. All customers should consult with a motor vehicle manufacturer or their dealer concerning the purchase and use of suitable tow vehicles for Keystone products. Keystone disclaims any liability or damages suffered as a result of the selection, operation, use or misuse of a tow vehicle. KEYSTONE'S LIMITED WARRANTY DOES NOT COVER DAMAGE TO THE RECREATIONAL VEHICLE OR THE TOW VEHICLE AS A RESULT OF THE SELECTION, OPERATION, USE OR MISUSE OF THE TOW VEHICLE. November 2008.