



BY TRAIL-LITE

EXPLORE

new directions



Super Lite-Weight Travel Trailers,
Expandables & Fifth Wheels



Trail-Cruiser Benefits

Aluminum Framed, Laminated Construction

Superior strength, light-weight, exceptional durability

Low Center of Gravity

Safe, stable towing with today's downsized tow vehicles

Fiberglass Exterior Skin

Easy to maintain, resistant to scratches, dents and dings

Aerodynamic Front Profile

Less wind buffeting for more stable towing

One-Piece Steel Chassis (Clean-Bond)

Not bolted together-welded for extra strength

Utility Storage Door

Easy access for camping accessories

Roto-Cast Holding Tanks

Seamless and light-weight

Rubber Roof

More durable, lighter, quieter

Torflex Axle

Independent, rubberized, suspension, EZ-Lube™ hubs, 5 year warranty

Ducted Air-Conditioning

All fifth wheels and travel trailers 26' and above



Fold Down Bed

Saves space while providing comfortable sleeping quarters.



Dexter Torsion Axle

Easy lube hubs, independent suspension – creates less sway and bounce for safer, easier towing.

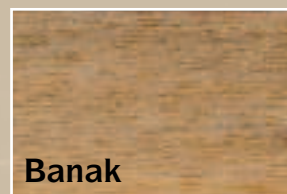

Banak

Hardwood, light-weight, 99% knot free; 1/3 the weight of pine. Used in framing cabinets for the Trail-Cruiser.



Pine

Used in framing cabinets by other RV manufacturers.

Expandable Floor Plans

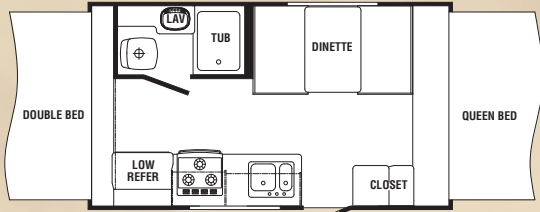

C17

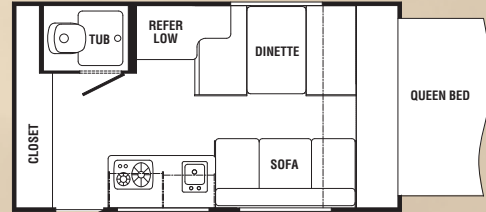

C17F

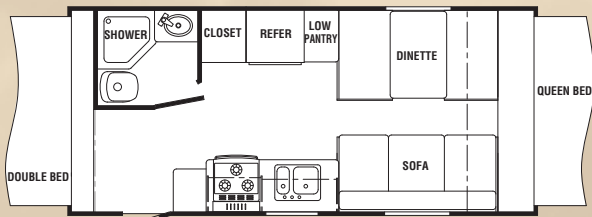

C191

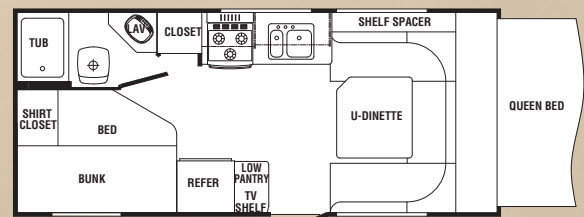

C21RBH

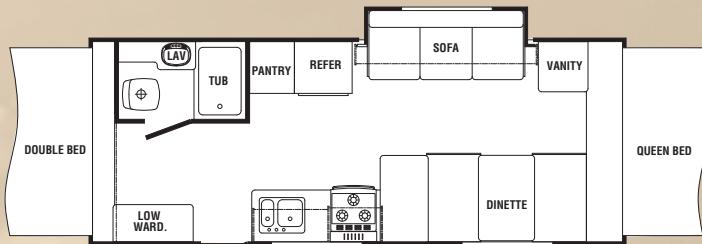

C23S

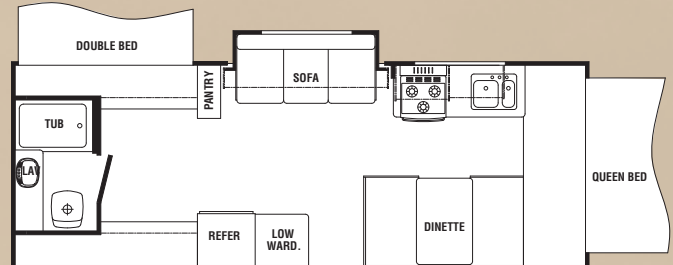

C243S

	C17	CF17F	C191	C21RBH	C23S	C243S
Length (Closed)	17'10"	17'10"	21'10"	22'5"	24'7"	26'2"
Length (Open)	20'10"	18'6"	23'8"	25'5"	27'7"	29'2"
Width (w/ Awning)	96"	96"	96"	96"	96"	96"
Height (w/AC)	9'8"	9'8"	9'8"	9'8"	9'8"	9'8"
Awning Length	10'	10'	12'	13'	15'	17'
Load Cap.	1162	1245	2428	2452	1604	2226
*Hitch Dry Wt. (Appr.)	255	260	279	385	334	491
*Axle Dry Wt. (Appr.)	2338	2255	2572	2548	3396	3374
*Total Dry Wt.	2593	2510	2851	2933	3730	3865
Fresh Water Tank Cap.	30	30	30	30	30	30
Grey Water Cap.	30	30	30	30	30	30
Black Water Cap.	30	30	30	30	30	30
Tire Size	205/75R14	205/75R14	205/75R14	205/75R14	205/75R14	205/75R14

*Weights are approximate and based on standard features, optional equipment not included.





Utility Door
Maximizes storage with the safety of a deadbolt.



Under the Bed Tub Storage
Engineered for easy accessibility while maximizing your living area.

Enclosed Heated Undercarriage

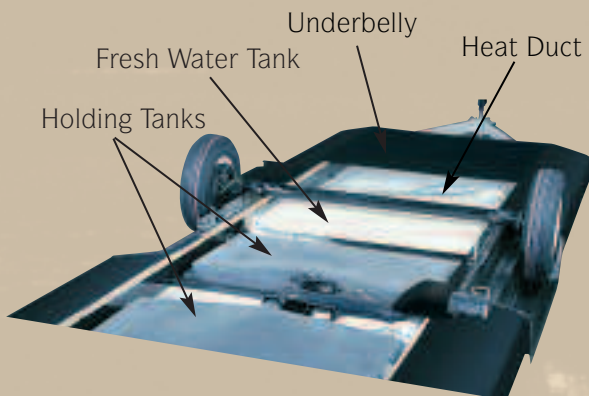

Liftco Slide-Out
High quality slide-out. Welded steel framework strengthens slide-out openings.



Hard Wall Floor Plans

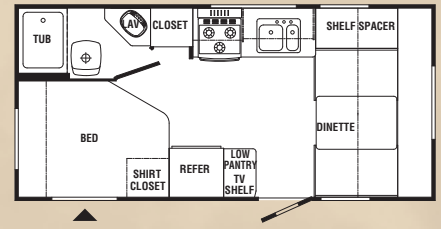

TC19RDB

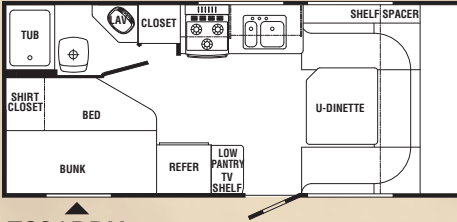

TC21RBH

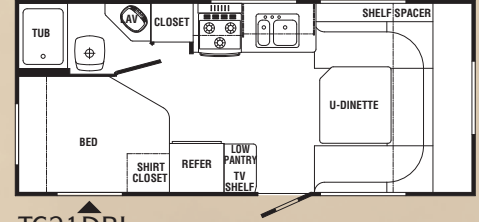

TC21DBL

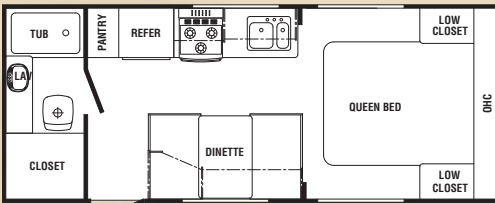

TC23QB

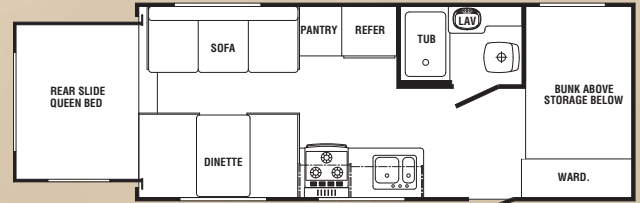

TC23SB



TC26QBH

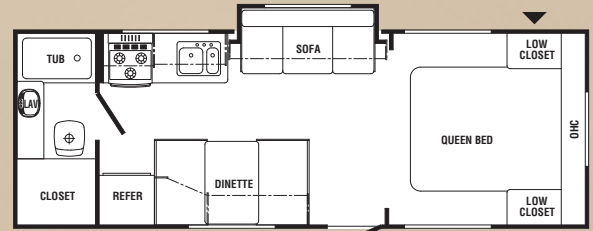

TC26QBS

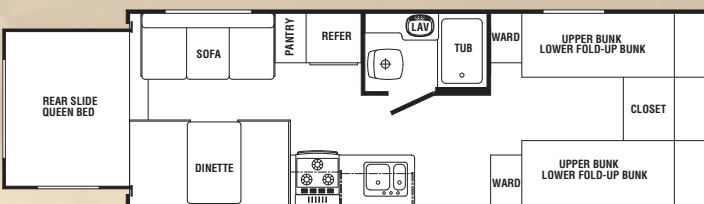

TC26SB

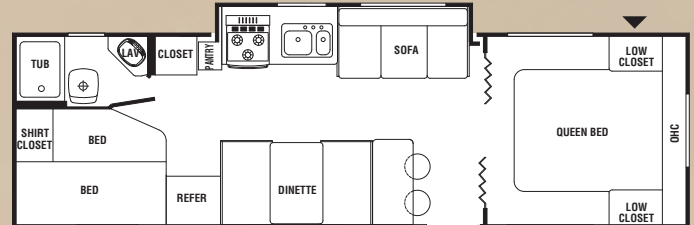

TC30QBSS

	TC19RDB	TC21DBL	TC21RBH	TC23QB	TC23SB	TC26QBH	TC26QBS	TC26SB	TC30QBSS
Length	21'2"	22'5"	22'5"	23'11"	25'6"	26'11"	26'11"	27'9"	31'7"
Width (w/o Awning)	96"	96"	96"	96"	96"	96"	96"	96"	96"
Height (w/AC)	9'8"	9'8"	9'8"	9'8"	9'8"	9'8"	9'8"	9'8"	9'8"
Awning Length	13'	13'	13'	14'	15'	18'	18'	18'	18'
Load Cap.	2590	2378	2508	2170	1644	2044	1940	1474	1588
* Hitch Dry Wt. (Appr.)	346	370	375	203	344	373	361	465	431
* Axle Dry Wt. (Appr.)	2410	2622	2492	2830	3356	2956	3060	3526	4012
* Total Dry Wt.	2756	2992	2867	3033	3700	3329	3421	3991	4439
Fresh Water Tank Cap.	30	30	30	30	30	30	30	30	30
Grey Water Cap.	30	30	30	30	30	30	30	30	30
Black Water Cap.	30	30	30	30	30	30	30	30	30
Tire Size	205/75R14	205/75R14	205/75R14	205/75R14	205/75R14	205/75R14	205/75R14	205/75R14	205/75R14

*Weights are approximate and based on standard features, optional equipment not included.

▲ Utility Storage Door

▼ Pass-Thru Storage

Fifth Wheel Floor Plans

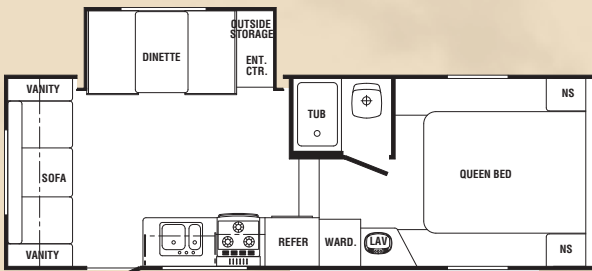

TC524DS

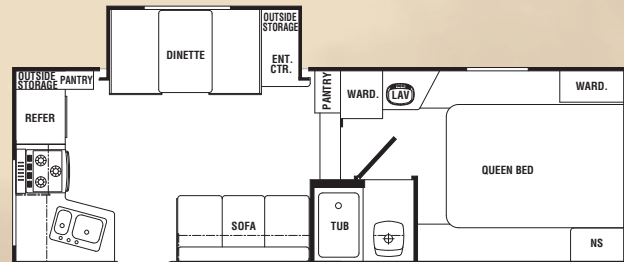

TC524RK

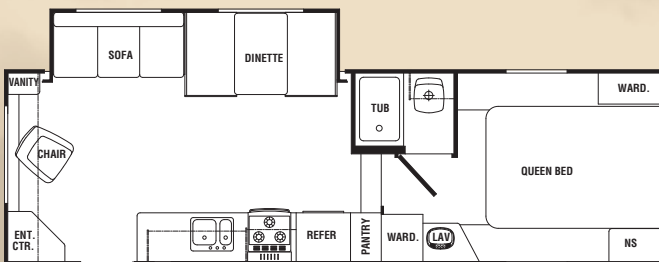

TC526RL

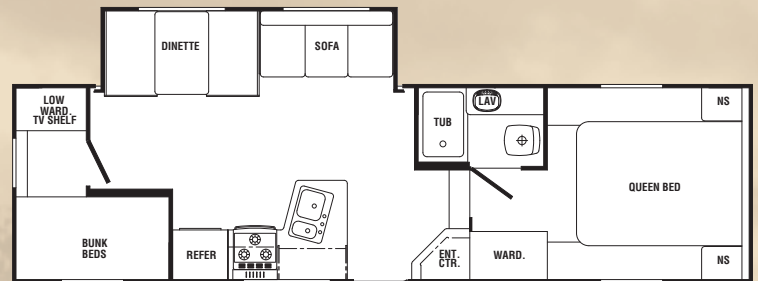

TC529BH

	TC524DS	TC524RK	TC526RL	TC529BH
Length (Closed)	25'10"	26'10"	28'	31'
Width (w/o Awning)	96"	96"	96"	96"
Height (w/AC)	11'6"	11'6"	11'6"	11'6"
Awning Length	15'	16'	17'	17'
Load Cap.	3124	2022	2136	2132
*Hitch Dry Wt. (Appr.)	1269	956	1053	1167
*Axle Dry Wt. (Appr.)	4286	4978	4864	5334
*Total Dry Wt.	5555	5934	5917	6501
Fresh Water Tank Cap.	30	30	30	30
Grey Water Cap.	40	30	30	60
Black Water Cap.	40	30	30	30
Tire Size	205/75R14	205/75R14C	205/75R14	205/75R14C

*Weights are approximate and based on standard features, optional equipment not included.



BRINGING YOU NEW OPPORTUNITIES TO EXPLORE

Standards & Options

	Travel Trailers	Expand-ables	Fifth Wheels		Travel Trailers	Expand-ables	Fifth Wheels
Appliances/Equipment				Hard Valances w/ Lambrequins in Living Area	•	•	•
Domestic Refrigerator, Flush Mount	•	•	•	Mini Blinds	•	•	•
3 Burner Range Top	•	•	•	No-Wax Vinyl Flooring	•	•	•
Power Range Hood w/Light	•	•	•	Mortise and Tenon Solid Wood Cabinet Doors	•	•	•
Monitor Panel	•	•	•	Roof Vent in Living Area (Deleted w/Optional Air Conditioning Some Models)	•	•	•
Six Gallon Gas Water Heater	•	•	•	Power Roof Vent in Bath	•	•	•
20,000 BTU Furnace	•	•	•	Inside - Outside Table (TC21RBH, TC21DBL, TC21RBH)	•	•	
Demand Water Pump	•	•	•	Bed Ends			
Laminated Plywood Countertops	•	•	•	Weathershield Tent (Attached Inside C-channel to Prevent Water Entry)		•	
Double Bowl Kitchen Sink	•	•	•	Continuous Piano Hinge for Added Strength		•	
Copper LP Gas Lines - Double Flared	•	•	•	Key Locked for Security		•	
Color Coded Water Lines	•	•	•	Compression Clamps Ensure Tight Bond of Bunk Seals		•	
Water Heater Bypass Kit	•	•	•	6" Bunk End Cushions for Comfort		•	
Bath				Pre-wired for Bunk Lights		•	
ABS Tub Surround or Shower Pan	•	•	•	Cable Supports for Bunk Ends-No Poles		•	
Shower Curtain w/Tieback	•	•	•	Running Gear			
Thetford Toilet	•	•	•	14" Radial Trailer Tires w/ Tandem Axles	•	•	•
Power Roof Vent	•	•	•	White Spoked Wheels	•	•	•
Adjustable Shower Head	•	•	•	Tandem Axles (N/A on C-17F and C-17)	•	•	•
Sink and Faucet	•	•	•	10" Electric Brakes, All Wheels	•	•	•
Medicine Cabinet w/Mirror	•	•	•	Galvanized Wheel Wells	•	•	•
Wall Mounted Light Switch	•	•	•	Torsion Bar Rubberized Independent Suspension System	•	•	•
Construction				E-Z Lube Hubs	•	•	•
Welded, Aluminum Framed, Laminated Roof with 1-1/2" Polystyrene Block Foam Insulation (R-7), Rubber Roof	•	•	•	Safety			
Welded, Aluminum Framed, Laminated Walls with 1-1/2" Polystyrene Block Foam Insulation (R-7), Fiberglass Exterior Covering	•	•	•	Electric Jacks 5th Wheel (Required)			•
Welded, Aluminum Framed, Laminated Floor with 1-1/2" Polystyrene Block Foam Insulation (R-7)	•	•	•	Break-A-Way Switch	•	•	•
Framed, Braced and Wired for Air Conditioning	•	•	•	Fire Extinguisher	•	•	•
Rotocast Holding Tanks	•	•	•	Smoke Detector	•	•	•
Rotocast Fresh Water Tank	•	•	•	LP Detector	•	•	•
Electrical				Safety Chains	•	•	•
Patio Light w/Amber Lens	•	•	•	Ground Fault Protected Circuit(s)	•	•	•
Ceiling Lights	•	•	•	Dead Bolt Door Lock	•	•	•
120 Volt GFI Protected Circuit(s)	•	•	•	Triple Entry Step	•	•	•
120 Volt Breaker Panel	•	•	•	Options			
Outside 120 Volt Receptacle	•	•	•	Air Conditioning,			
30 Amp, 28' Power Cord (Detachable)	•	•	•	13,500 BTU	•	•	•
55 Amp Converter w/Charger	•	•	•	15,000 BTU	•	•	•
Battery Rack	•	•	•	Awning, A & E	•	•	•
Pre-Wired for Microwave	•	•	•	Spare Tire, Wheel & Carrier	•	•	•
Exterior				Stabilizer Jacks (4) (STD in Expandable)	•	•	•
Rubber Roof	•	•	•	TV Antenna/Cable	•	•	•
Fiberglass Skin	•	•	•	Outside Grill	•	•	•
Clean Bond Painted Chassis	•	•	•	AM/FM CD Player	•	•	•
Radius Tinted Windows	•	•	•	Microwave	•	•	•
Flush Mounted Front Window Awning	•	•	•	Oven	•	•	•
Radius Entry Door w/Window, Deadbolt Lock and Screen Door	•	•	•	Roof Ladder	•	•	•
Outside Storage Compartment	•	•	•	Outside Sliding Storage Drawer	•	•	•
Self-Storage Step	•	•	•	Outside Shower	•	•	•
20# LP Tanks with Cover	•	•	•	D.S.I. Water Heater	•	•	•
2-5/16" Coupler	•	•	•	2 Door Refrigerator (19' Models & Above)	•	•	•
Utility Door Corner Beds	•	•	•	Stove Cover	•	•	•
Radius Baggage Door	•	•	•	Monitor Panel (STD in TT)	•	•	•
Automotive "D" Seal on all Windows	•	•	•	Fan-Tastic Fan	•	•	•
Interior				2 Bar Stools	•	•	•
Large Galley Window	•	•	•	Double Entry Step	•	•	•
5" Reversible Dinette and Bunk Cushions	•	•	•				

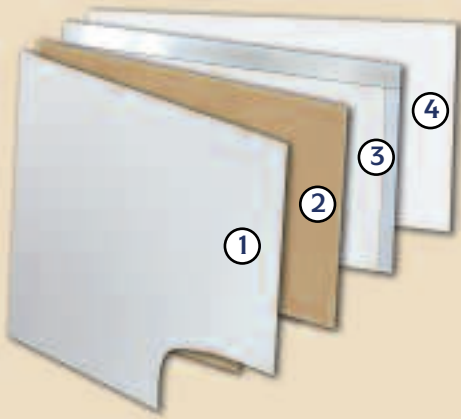

Sidewall 2" Thick Laminate R-7

1. Fiberglass Skin - dent resistant, low maintenance
2. Luan
3. Aluminum Frame and Foam
4. Wallboard

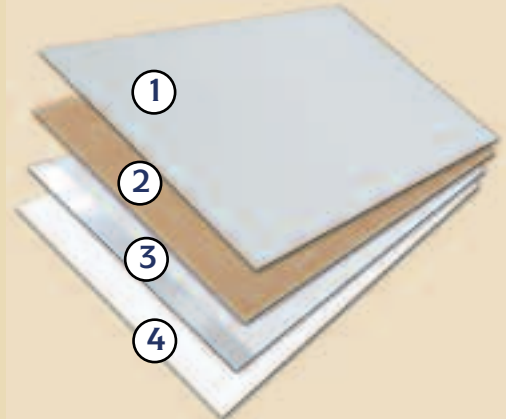

Roof 2" Thick R-7 3" Thick R-13 (26' & Above)

1. Rubber Roof
2. Luan
3. Aluminum Frame and Foam
4. Ceiling Board

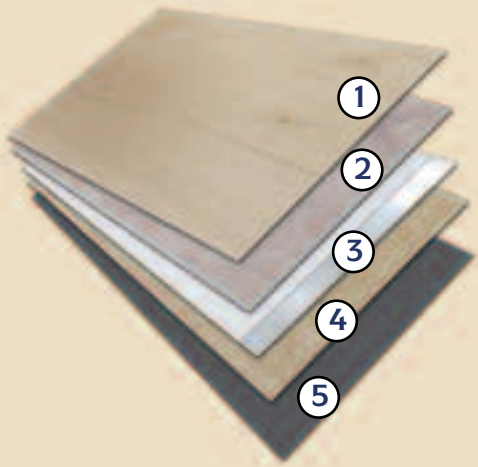

Floor 2" Thick Laminate R-7

1. Luan
2. Luan
3. Aluminum Frame and Foam
4. Luan
5. Darco



Towing Guide

Listed below are tow ratings that are the highest available for the respective 2004 models. Certain optional equipment may be required and other restrictions may apply. Check with your automotive dealer for exact specifications.

VEHICLE	ENGINE	TOW LIMIT
Acura		
MDX	3.5 V-6	3500
RL	3.5 V-6	2000
AM General		
Hummer H2	6.0 V-8	6700
Buick		
Rendezvous	3.4 V-6	3500
BMW		
X5	4.6 V-8	5950
X5	4.4 V-8	5950
Cadillac		
Escalade AWD	6.0 V-8	8200
SRX	ALL	3500
Chevrolet/GMC		
Astro/Safari (AWD)	4.3 V-6	5000
Astro/Safari (RWD)	4.3 V-6	5200
Blazer/Jimmy (4WD)	4.3 V-6	5500
Colorado	3.5 I-5	4000
Express/Savana/G1500	5.3 V-8	6200
Express/Savana/G1500	5.3 V-8	6600
Express/Savana/G2500	6.0 V-8	8400
Express/Savana/G2500/3500	6.0 V-8	8300
K1500 Ext. Cab. (4WD)	4.8 V-6	6600
S Series/Sonoma	4.3 V-6	5200
Silverado/Sierra/C/K 1500	4.3 V-6	4800
Chrysler		
Town & Country	3.3, 3.8 V-6	3800
Dodge		
Caravan	3.3, 3.8 V-6	3800
Caravan	3.8 V-6	3500
Dakota (2WD) Reg. Cab.	3.7 V-6	4900
Dakota (2WD) Reg. Cab.	3.7 V-6	5300
Dakota (2WD) Reg. Cab.	4.7 V-8	5600
Dakota (2WD) Club Cab.	4.7 V-8	6450
Dakota (4WD) Reg. Cab.	3.7 V-6	3850

Dakota (4WD) Reg. Cab.	4.7 V-8	6300
Dakota (4WD) Club Cab.	3.7 V-6	4500
Dakota (4WD) Club Cab.	4.7 V-8	5100
Durango (4WD)	4.7 V-8	5700
Durango (4WD)	5.9 V-8	7300
Ram (2WD) 1500 All Cab.	4.7 V-8	5750
Ram (4WD) 1500 All Cab.	5.7 V-8	7300
Ram Quad B1500	4.7 V-8	5400
Ram Quad B2500	3.7 V-8	8300
Ford		
Econoline Van	4.6 V-8	6500
Econoline Van	5.4 V-8	6900
Expedition (4WD)	4.6 V-8	5000
Expedition (2WD)	4.6 V-8	5000
Expedition (4WD)	5.4 V-8	6000
Explorer (2WD)	4.0 V-6	5780
Explorer (4WD)	4.0 V-6	5380
F-150 Reg. Cab. (2WD)	4.2 V-6	3500
F-150 Reg. Cab. (2WD)	4.6 V-8	5800
Infiniti		
FX 35/45	ALL	3500
Honda		
Pilot	3.5 V-6	3500
Odyssey	3.5 V-6	3500
Hyundai		
Santa Fe (2WD)	2.7 V-6	3200
Santa Fe (4WD)	2.7 V-6	2700
Isuzu		
Rodeo/Rodeo Sport	2.2, 2.6 I-4	2500
Rodeo	3.2 V-6	4500
Ascender (4WD)	4.2 I-6	5300
Axiom	3.5 V-6	7000
Jeep		
Grand Cherokee	4.0 I-6	5000
Grand Cherokee	4.7 V-8	6500
Liberty	2.4 I-4	2000
Liberty	3.7 V-6	5000

Wrangler	4.0 I-6	2000
Kia		
Sedona	3.5 V-6	3500
Sorento	3.5 V-6	3500
Land Rover		
Discovery	ALL	5500
Range Rover	ALL	7700
Lexus		
RX300	3.3 V-6	3500
LX470	4.7 V-8	6500
Lincoln		
Aviator	4.6 V-8	7100
Navigator	5.4 V-8	8800
Mazda		
B3000 (4WD)	3.0 V-6	2560
B4000	4.0 V-6	5760
B4000 (4WD)	4.0 V-6	5580
Tribute	3.0 V-6	3500
Mercedes-Benz		
C-500	5.0 V-8	7000
ML 350	3.7 V-6	5000
ML 500	5.0 V-8	5000
ML5AMG	5.4 V-8	7000
Mercury		
Mountaineer	4.0 V-6	5460
Mountaineer	4.6 V-8	7300
Villager	3.3 V-6	3500
Mitsubishi		
Montero Limited, XLS	3.5 V-6	5000
Montero Sport ES, LS	3.0 V-6	5000
Endeavor	3.8 V-6	3500
Nissan		
Pathfinder	3.5 V-6	5000
Frontier (4WD)	3.3 V-6	5000
Xterra	3.3 V-6	5000
Quest	3.5 V-6	3500
Oldsmobile		

Bravada	4.2 I-6	6300
Silhouette	3.4 V-6	3500
Pontiac		
Aztec	3.4 V-6	3500
Montana	3.4 V-6	3500
Subaru		
Legacy/Outback/Forester	2.5 SOHC I-4	2000
Toyota		
4 Runner	3.4 V-6	5000
Land Cruiser	4.7 V-8	6500
Sienna	3.3 V-6	3500
Tacoma	3.4 V-6	5000
Tundra (4WD)	4.7 V-8	7200

OPTIONS	APPROX. WT. (LBS.)
Air Conditioning, 13,500 BTU	104
Air Conditioning, 15,000 BTU	110
AM/FM CD Player	4
Awning, A & E	40-60
Swivel Rocker Chair	35
Microwave	30
Oven	30
Spare Tire & Wheel	35
Stabilizer Jacks (Four)	24
TV Antenna/Cable/Satellite Ready	6
Roof Ladder	5
Outside Grill	15
Outside Shower	3
Outside Sliding Drawer	36
Sink Cover	1
Stove Cover	1
Tub Surround	10
Double Entry Step	7
Chrome Trim Rings w/Cap	3
Raised Panel Overhead Door	5
Raised Panel Refer Door	3
Fan-Tastic Fan	15
2 Bar Stools	20

R-Vision, Inc.

2666 S. Country Club Drive
Warsaw, IN 46580
www.trail-lite.com



Our 58 acre complex in Warsaw, Indiana

As R-Vision constantly strives to improve our product, all specifications listed in this informative brochure are subject to change without notice or obligation. Photos may show optional equipment which is not included in the purchase price of the unit. Test drive and review a current model on your dealer's lot today.
2006 R-Vision, Inc. R-100-166

Your Dealer