



*Gear Up And Go!*



**XLR**

**2012 XLR VIPER FEATURES**

**XLR VIPER DECOR CHOICES**

PLATINUM

ONYX

BRONZE

**INTERIOR FEATURES**

- Raised Panel Cognac Maple Cabinetry
- Premium Cabinet Hardware
- AM/FM/CD/MP3 Stereo w/DVD Player
- 13.5K BTU Ducted Air Conditioner
- 100 Gallon Fresh Water Tank
- 12V Battery Disconnect
- Fantastic Fan – Bathroom
- Contemporary Vinyl Tile Flooring
- Plush Residential Bedding (29CKV, 5W)
- Pillow Top Mattress (29CKV, 5W)
- Diamond Plate Tread-Guard in Cargo Areas
- Temperature Controlled Cargo Areas (5W)
- 32" Living Room LCD HDTV (5W)
- Deep Bowl Stainless Steel Kitchen Sink
- Sink Covers
- 99" Interior Width
- Black Radius Front Refrigerator
- Recessed Halogen Lighting
- 5,000 lb Steel Reinforced Tie Downs
- Foot Flush Porcelain Toilet

- Oil & Gas Resistant Rubber Flooring
- Retractable Hid-N-Screen
- 100 AMP Converter
- Single 12V Electric Bed

**EXTERIOR FEATURES**

- Aerodynamic V-Front Profile Design
- Gel Coat Front Cap
- POLYDET® High Gloss Fiberglass Sidelalls
- Vacuum-Bonded Aluminum Framed Construction
- 5/8" Laminated Floor Decking
- Dual Battery Prep
- Reverse Activated Rear Flood Lights
- LED Brake Lights and Marker Lights
- Powder Coated Steel I-Beam Chassis
- 30 AMP Service
- NitroFill™ Radial Tires
- Ultraview Frameless Windows
- Electric Awning (5Ws)
- EZ Lube Axles
- Rain Gutter Drip Spouts
- 102" Wide Body Construction

**OPTIONAL EQUIPMENT**

- **Convenience Package** (Mandatory – awning, spare tire, ladder, black tank flush, hid-n-screen, 13.5K A/C, 6 gal. DSI water heater, forced air furnace)
- **Extreme Package** (12V heated holding tanks, dual pane windows, enclosed underbelly, double insulation in roof)
- Power Tongue Jack
- Outside Shower
- Aluminum Wheels
- Electric Stabilizer Jacks
- Frame Mounted Toy Lok
- 4.0kW Onan CARB EVAP Generator (29CKV)
- 5.5kW Onan CARB EVAP Generator
- Mobile Fuel Station w/Fuel Tank
- 15K A/C IPO 13.5K BTU
- 2nd Air Conditioner – Bedroom
- Living Room LCD TV (TT)
- Sport Rockers (2) IPO Roadside Sofa
- Removable Cargo Carpet Kit
- Dual Electric Beds
- Electric Bed w/Bottom Pass Thru Dinette
- Electric Bed IPO Murphy Bed (29MBV)

**XLR VIPER FIFTH WHEEL SPECIFICATIONS**

Model	Hitch Weight	Ship Weight	GVWR	Cargo Capacity	Exterior Length	Exterior Height	Exterior Width	Fresh Water	Gray Water	Black Water	Awning Size
305V10	1730	9649	13730	4081	36'0"	13'2"	102"	100	64	32	18'
305V12	1572	10220	13572	3352	37'8"	13'2"	102"	100	64	32	18'
305V14	1919	11736	18000	6264	39'9"	13'2"	102"	100	64	32	18'

**F305V14  
F305V12  
F305V10**

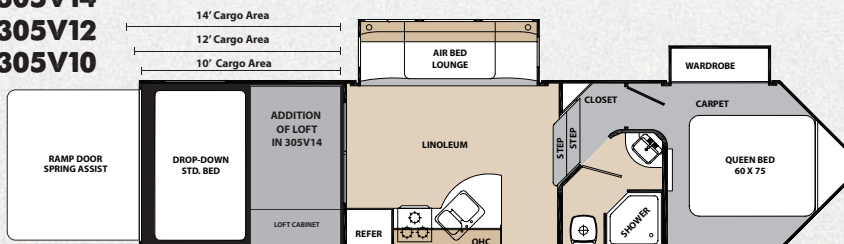

**VIPER'S V-NOSE ADVANTAGES**

- Increased aerodynamics for easier towing
- 75 Cubic feet of storage capacity at the V-nose
- Improved fuel efficiency
- Decreased wind resistance

*This Fifth Wheel is available in 3 garage lengths to accommodate all your gear!*



### XLR VIPER TRAVEL TRAILER SPECIFICATIONS

Model	Hitch Weight	Ship Weight	GVWR Length	Cargo Capacity	Exterior Length	Exterior Height	Exterior Width	Fresh Water	Gray Water	Black Water	Awning Size
23FBV	779	6123	9579	3456	25'0"	11'0"	102"	100	32	32	18'
25FKV	1003	6137	9803	3666	27'9"	11'0"	102"	100	32	32	18'
29CKV	1304	7329	11464	4135	32'3"	11'0"	102"	100	32	32	18'
29MBV	1364	7385	11524	4139	31'6"	11'0"	102"	100	64	32	23'

#### 23FBV

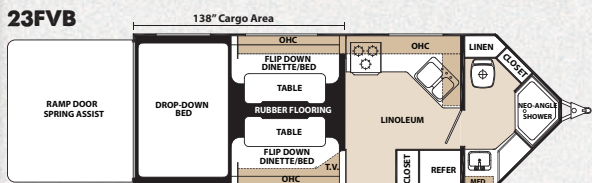

#### 25FKV

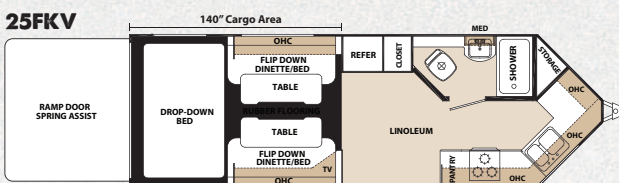

#### 29CKV

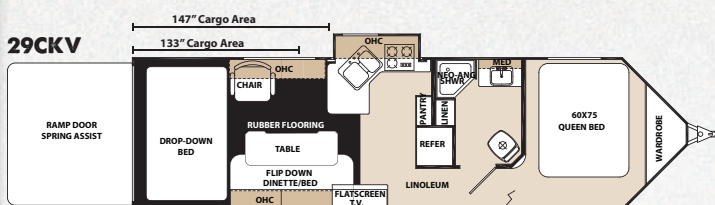

#### 29MBV

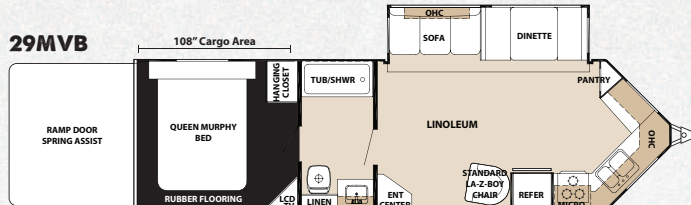

### YOUR XLR VIPER DEALER

**XLR**  
Gear Up And Go!



**Learn More**  
Scan this barcode using a QR Reader on your smart phone to learn more about Forest River.



A Berkshire Hathaway company.

CHECK US OUT ON:

**FOREST RIVER**  
2431 E. Kercher Road ■ Goshen, IN 46526  
E-mail: [XLRinfo@forestriverinc.com](mailto:XLRinfo@forestriverinc.com)  
Phone: 574-975-0279 ■ Fax: 574-343-5909  
[www.forestriverinc.com/XLR](http://www.forestriverinc.com/XLR)  
[www.forestriveraccessories.com](http://www.forestriveraccessories.com)

Actual towing capacity is dependent on your particular loading and towing circumstances, which includes GVWR, GAWR and GCWR, as well as adequate trailer brakes. Please refer to the Owners Manual of your vehicle for further information. Floor plans, features and specifications are subject to change without notice. 8/11/10K ©2011 XLR



Strike Out For Adventure  
Get Where the Action Is  
Go Where the Action Is  
Go For It!  
Gear Up And Go  
Extreme Action